

---

---

**APPENDIX F**  
**PARKWAY MAPS**

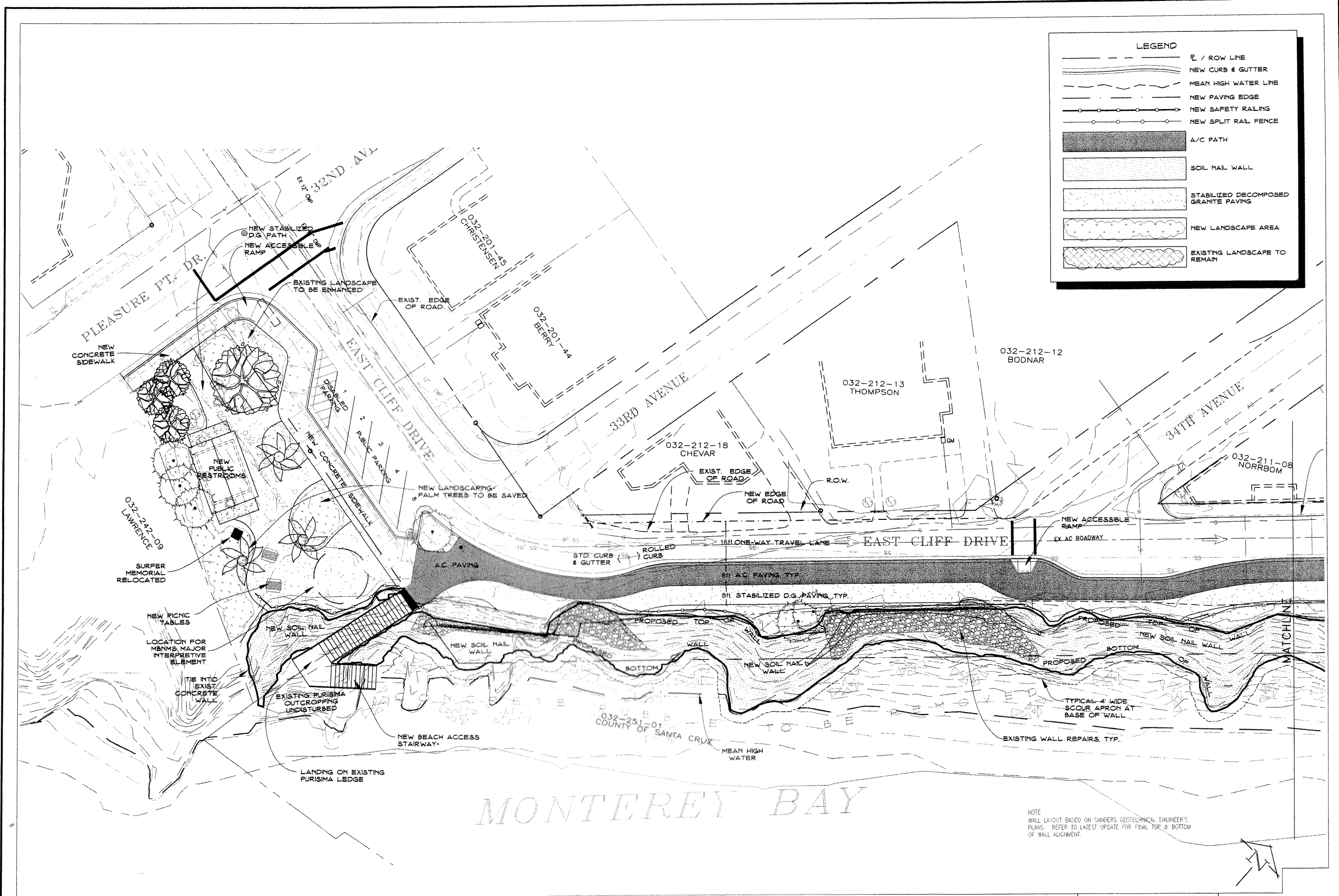



**LEGEND**

- ROW LINE
- NEW CURB & GUTTER
- MEAN HIGH WATER LINE
- NEW PAVING EDGE
- NEW SAFETY RAILING
- NEW SPLIT RAIL FENCE
- A/C PATH
- SOIL NAIL WALL
- STABILIZED DECOMPOSED GRANITE PAVING
- NEW LANDSCAPE AREA
- EXISTING LANDSCAPE TO REMAIN

NOTE: WALL LAYOUT BASED ON SANDERS GEOTECHNICAL ENGINEER'S PLANS. REFER TO LATEST UPDATE FOR FINAL TOP & BOTTOM OF WALL ALIGNMENT.

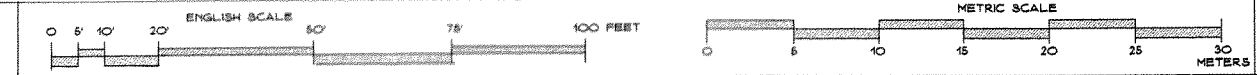

SHEET NAME: EC-S1

DRAWING NAME: ECLIFF.DWG

BY	
REVISION	
DATE	
SANTA CRUZ COUNTY REDEVELOPMENT AGENCY 701 OCEAN STREET, SANTA CRUZ, CA 95060 PHONE: (831) 454-2280 FAX: (831) 454-3420	
COUNTY OF SANTA CRUZ - DEPARTMENT OF PUBLIC WORKS	
<b>EAST CLIFF DRIVE PARKWAY PLAN</b>	
PEDESTRIAN & BIKE PATH SITE PLAN	
DRAWN: AK	
CHECKED: PR	
DATE: 7/28/06	
SCALE: 1:200	
JOB NO.	
SHEET	
S1 of 27	

**LEGEND**

- R / ROW LINE
- NEW CURB & GUTTER
- MEAN HIGH WATER LINE
- NEW PAVING EDGE
- NEW SAFETY RAILING
- NEW SPLIT RAIL FENCE
- A/C PATH
- SOIL NAIL WALL
- STABILIZED DECOMPOSED GRANITE PAVING
- NEW LANDSCAPE AREA
- EXISTING LANDSCAPE TO REMAIN

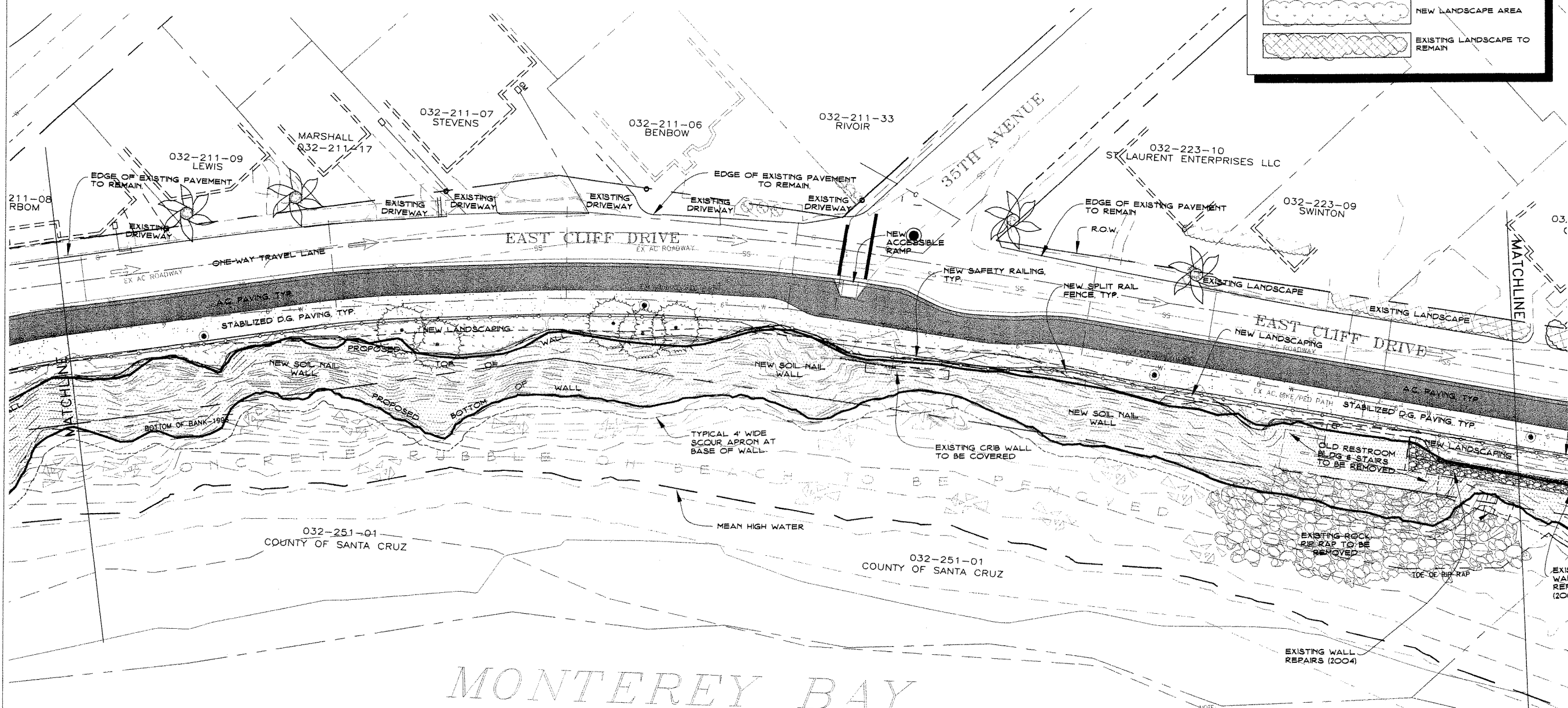

MONTEREY BAY

NOTE:  
WALL LAYOUT BASED ON SANDERS GEOTECHNICAL ENGINEER'S PLANS. REFER TO LATEST UPDATE FOR FINAL TOP & BOTTOM OF WALL ALIGNMENT.

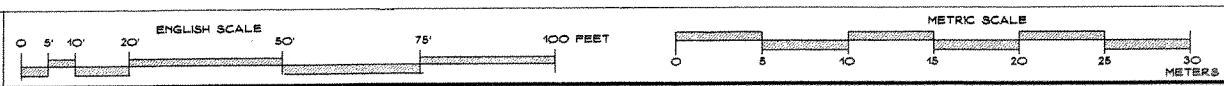

SHEET NAME: EC-S2 DRAWING NAME: ECLIFF.DWG

BY	
REVISION	
DATE	
SANTA CRUZ COUNTY REDEVELOPMENT AGENCY	
701 OCEAN STREET, SANTA CRUZ, CA 95060	
PHONE: (831) 454-2280 FAX: (831) 454-3420	
COUNTY OF SANTA CRUZ - DEPARTMENT OF PUBLIC WORKS	
EAST CLIFF DRIVE	
PARKWAY PLAN	
PEDESTRIAN & BIKE PATH SITE PLAN	
DRAWN: AK	
CHECKED: PR	
DATE: 7/28/06	
SCALE: 1:200	
JOB NO.	
SHEET	
S2-27	

LEGEND	
	℄ / ROW LINE
	NEW CURB & GUTTER
	MEAN HIGH WATER LINE
	NEW PAVING EDGE
	NEW SAFETY RAILING
	NEW SPLIT RAIL FENCE
	A/C PATH
	SOIL NAIL WALL
	STABILIZED DECOMPOSED GRANITE PAVING
	NEW LANDSCAPE AREA
	EXISTING LANDSCAPE TO REMAIN

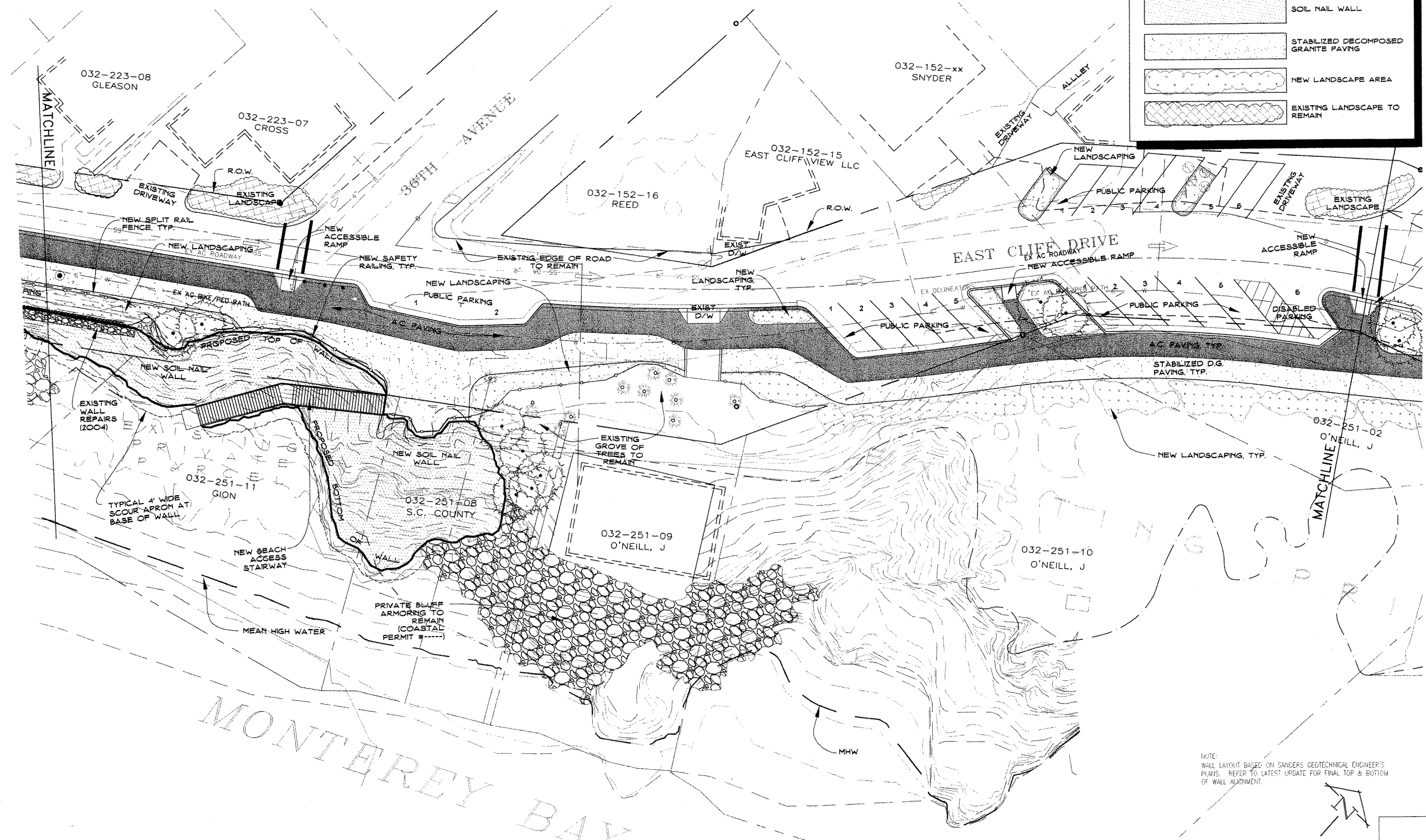

NOTE: WALL LAYOUT BASED ON SANDERS GEOTECHNICAL ENGINEER'S PLANS. REFER TO LATEST UPDATE FOR FINAL TOP & BOTTOM OF WALL ALIGNMENT.



SHEET NAME: EC-S3

DRAWING NAME: ECLIFF.DWG

BY:	
REVISION:	
DATE:	
SANTA CRUZ COUNTY REDEVELOPMENT AGENCY	
701 OCEAN STREET, SANTA CRUZ, CA 95060	
PHONE: (831) 454-2280 FAX: (831) 454-3420	
COUNTY OF SANTA CRUZ - DEPARTMENT OF PUBLIC WORKS	
EAST CLIFF DRIVE	
PARKWAY PLAN	
PEDESTRIAN & BIKE PATH SITE PLAN	
DRAWN: AK	
CHECKED: PR	
DATE: 7/28/06	
SCALE: 1:200	
JOB NO.	
SHEET	
S3 of 27	

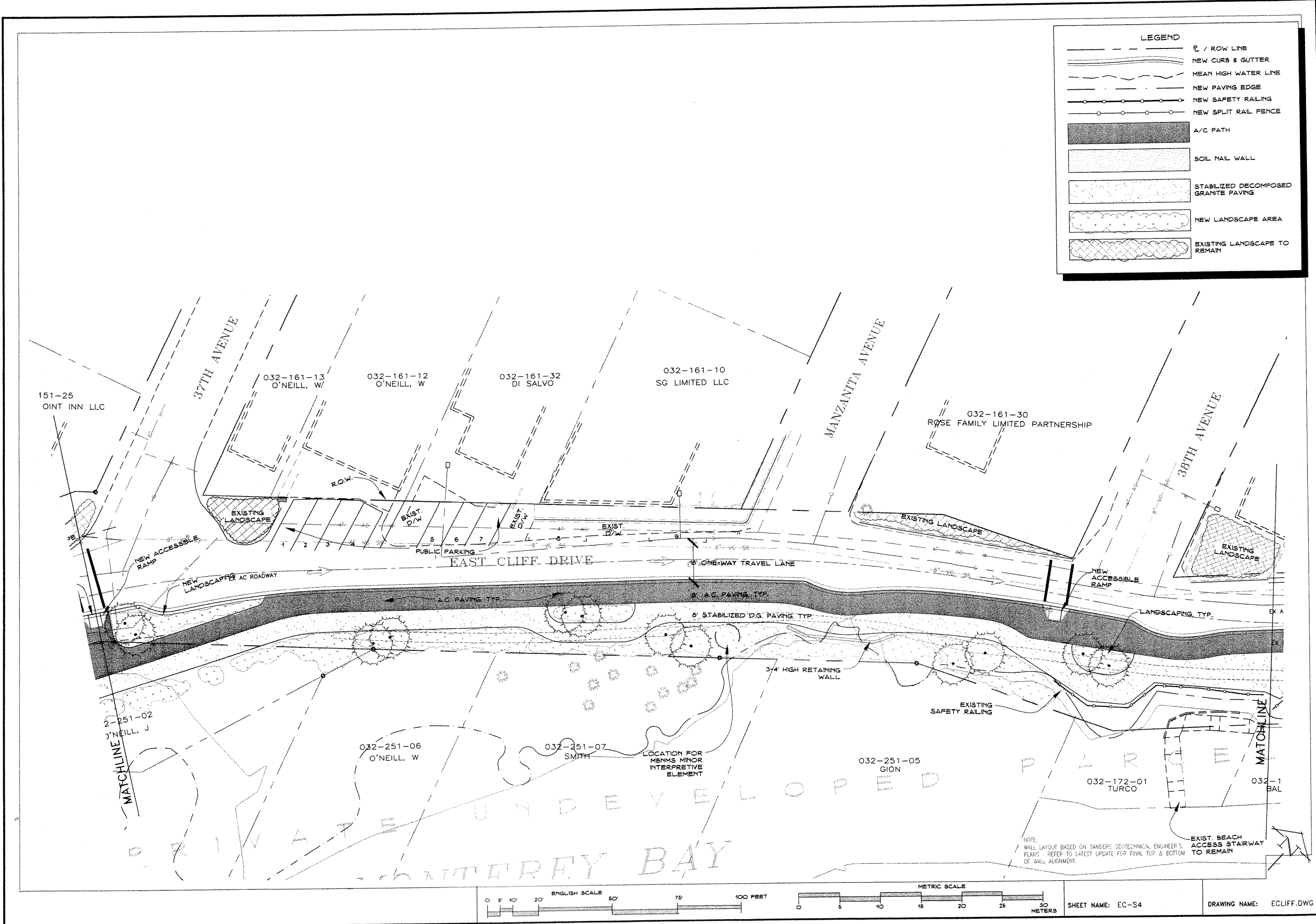

**LEGEND**

- P / ROW LINE
- NEW CURB & GUTTER
- MEAN HIGH WATER LINE
- NEW PAVING EDGE
- NEW SAFETY RAILING
- NEW SPLIT RAIL FENCE
- A/C PATH
- SOIL NAIL WALL
- STABILIZED DECOMPOSED GRANITE PAVING
- NEW LANDSCAPE AREA
- EXISTING LANDSCAPE TO REMAIN

BY	
REVISION	
DATE	
SANTA CRUZ COUNTY REDEVELOPMENT AGENCY 701 OCEAN STREET, SANTA CRUZ, CA 95060 PHONE: (831) 454-2280 FAX: (831) 454-3420	
COUNTY OF SANTA CRUZ - DEPARTMENT OF PUBLIC WORKS <b>EAST CLIFF DRIVE PARKWAY PLAN</b> PEDESTRIAN & BIKE PATH SITE PLAN	
DRAWN: AK	
CHECKED: PR	
DATE: 7/28/06	
SCALE: 1:200	
JOB NO.	
SHEET	S4 of 27



SHEET NAME: EC-S4  
DRAWING NAME: ECLIFF.DWG



**LEGEND**

- / --- ROW LINE
- NEW CURB & GUTTER
- MEAN HIGH WATER LINE
- NEW PAVING EDGE
- NEW SAFETY RAILING
- NEW SPLIT RAIL FENCE
- A/C PATH
- SOIL NAIL WALL
- STABILIZED DECOMPOSED GRANITE PAVING
- NEW LANDSCAPE AREA
- EXISTING LANDSCAPE TO REMAIN

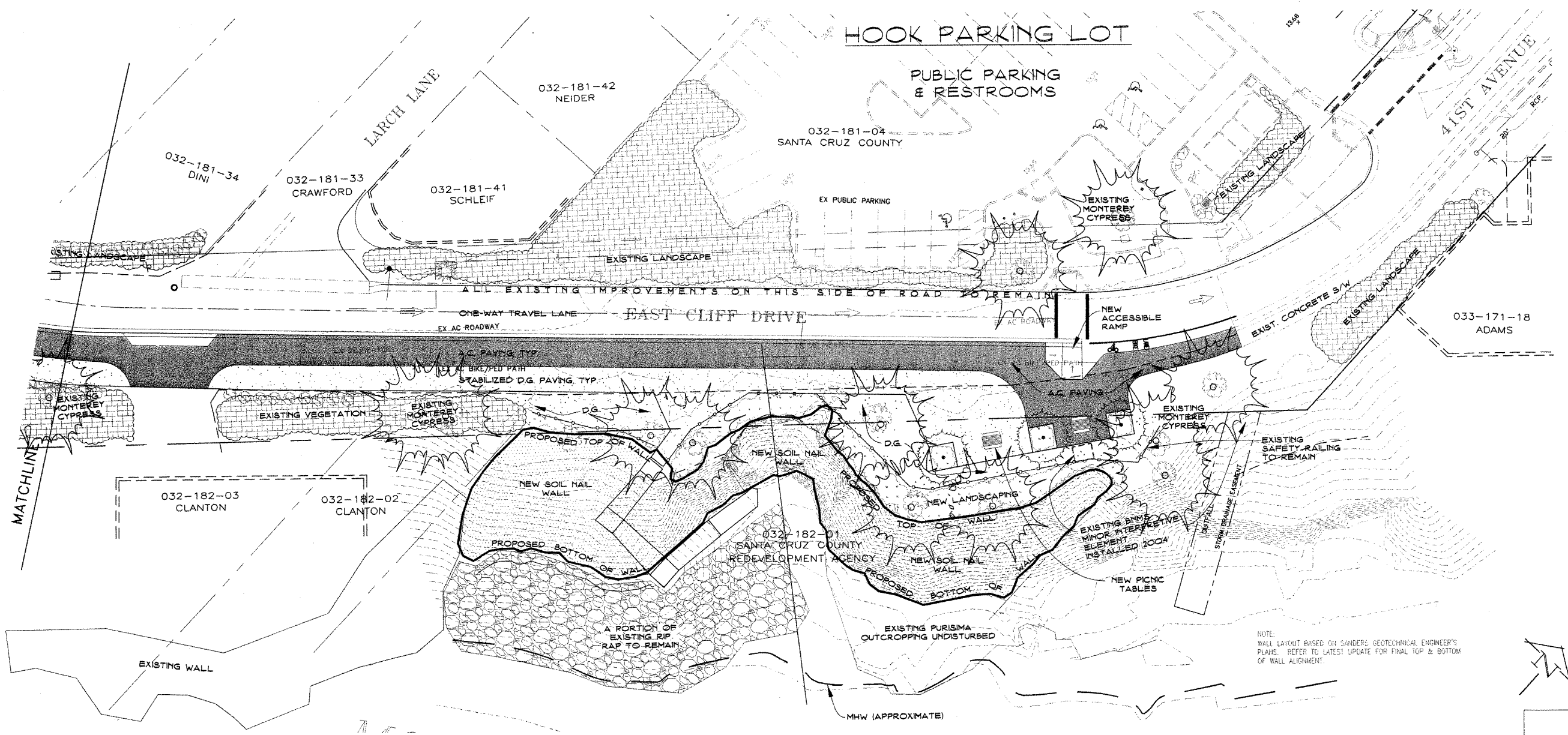

NOTE: WALL LAYOUT BASED ON SANDERS GEOTECHNICAL ENGINEER'S PLANS. REFER TO LATEST UPDATE FOR FINAL TOP & BOTTOM OF WALL ALIGNMENT.

SHEET NAME: EC-S6  
 DRAWING NAME: ECLIFF.DWG

BY	
REVISION	
DATE	
SANTA CRUZ COUNTY REDEVELOPMENT AGENCY	
701 OCEAN STREET, SANTA CRUZ, CA 95060	
PHONE: (831) 454-2280 FAX: (831) 454-3420	
COUNTY OF SANTA CRUZ - DEPARTMENT OF PUBLIC WORKS	
<b>EAST CLIFF DRIVE</b>	
<b>PARKWAY PLAN</b>	
PEDESTRIAN & BIKE PATH SITE PLAN	
DRAWN: AK	
CHECKED: PR	
DATE: 7/28/06	
SCALE: 1:200	
JOB NO.	
SHEET	
<b>S6 of 27</b>	